

CUT LINE (REFER TO DRG NO. 5552/GA/304)

DO NOT SCALE

- NOTES:
1. ALL DIMENSIONS ARE IN METRES UNLESS OTHERWISE STATED.
 2. DO NOT SCALE FROM THIS DRAWING.
 3. THIS IS A FEASIBILITY DESIGN AND IS NOT TO BE USED FOR CONSTRUCTION. IT HAS BEEN BASED ON OS DATA THEREFORE THE ACCURACY OF THE DIMENSIONS CAN NOT BE GUARANTEED.

- KEY:
- HIGHWAY BOUNDARY
 - ▶ EXISTING BUS STOP (FLAG)
 - ▭ EXISTING BUS SHELTER
 - ▭ EXTENT OF EXISTING PARKING (INDICATIVE)
 - ↔ EXISTING CROSSING POINT
 - EXISTING SIGNALISED CROSSING OR JUNCTION
 - ▭ PROPOSED SHARED USE PATH

THIS DRAWING CONSTITUTES RECOMMENDATIONS FOR INFORMATION PURPOSES ONLY. AS SUCH IT SHOULD NOT BE USED FOR ANY CONSTRUCTION WORKS

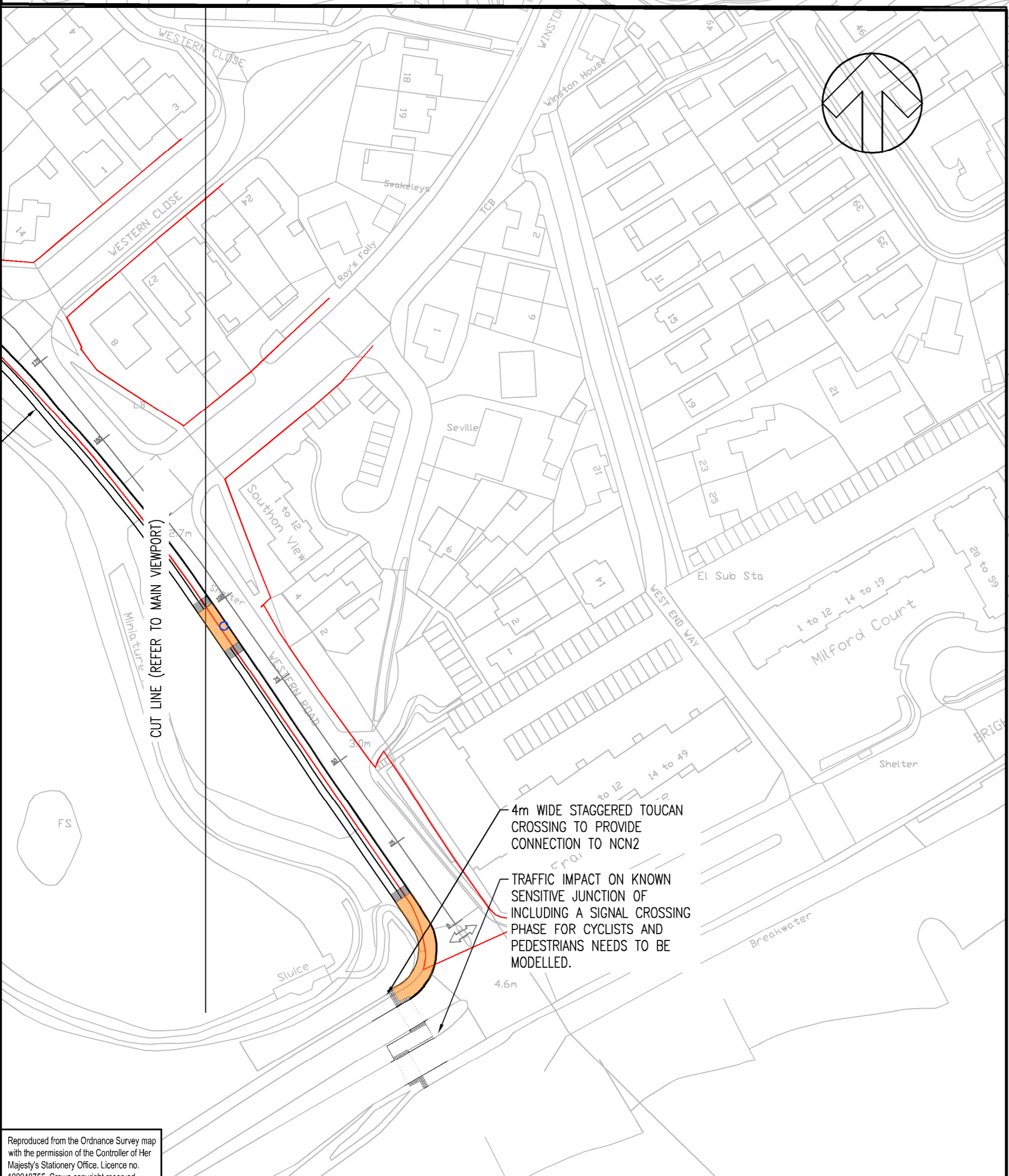
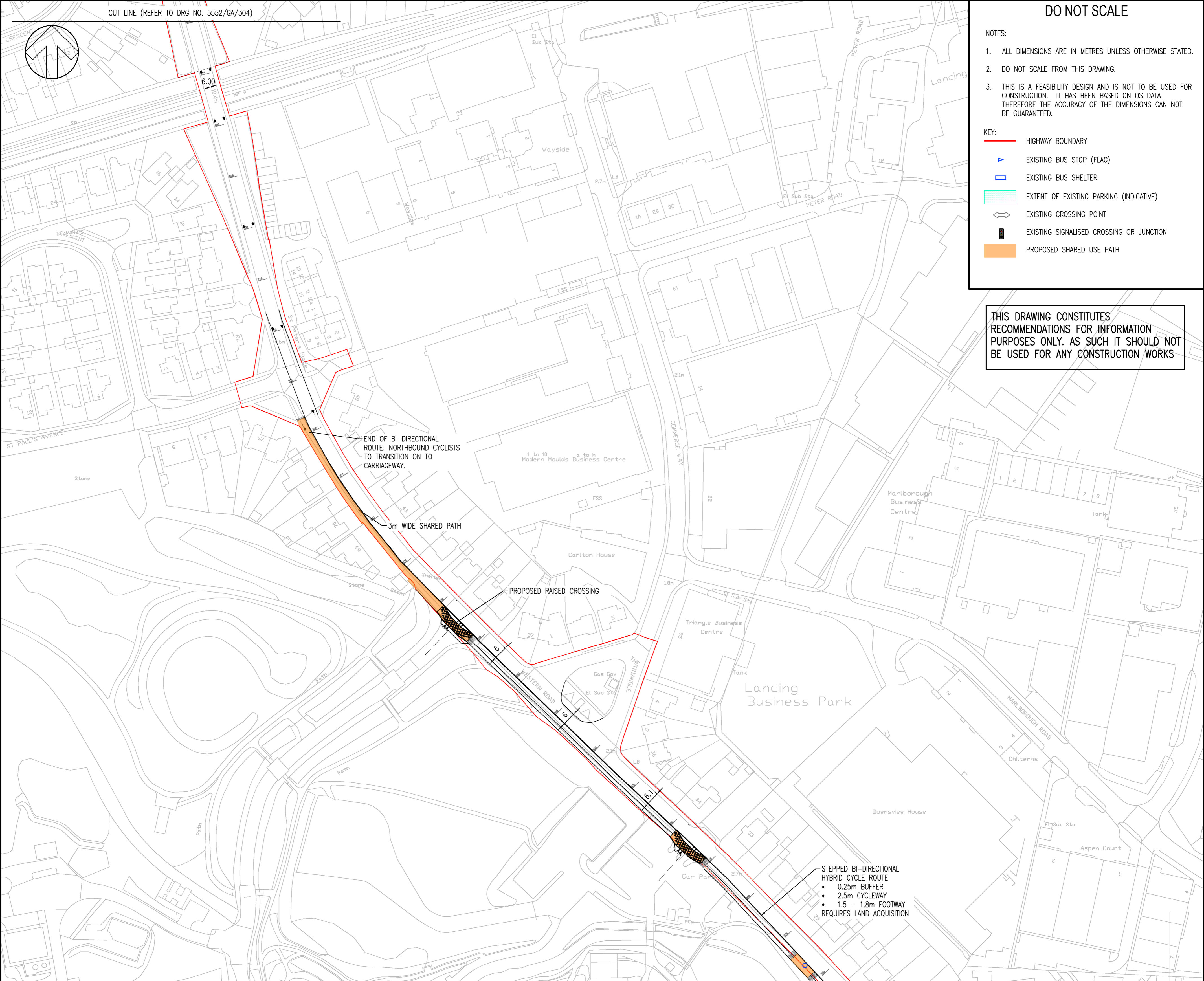

<p>Reproduced from the Ordnance Survey map with the permission of the Controller of Her Majesty's Stationery Office. Licence no. 100048755. Crown copyright reserved.</p>		<p>Client: WEST SUSSEX COUNTY COUNCIL</p>		<p>Project: SHOREHAM STP PHASE 2 SOMPTING & LANCING HIGH QUALITY CYCLE ROUTE</p>		<p>Scale: 1:1000</p>		<p>Checked: HL</p>		<p>Approved: DP</p>	
<p>Regus House Southampton Int. Bus. Park George Curl Way Southampton SO18 2RZ, UK</p>		<p>Architect: WSP</p>		<p>Title: FEASIBILITY DESIGN SHEET 6 OF 8</p>		<p>Project No: 70025552</p>		<p>Designed: TPS</p>		<p>Date: February 19</p>	
<p>T+44 (0) 2380 302 529 F+44 (0) 2380 302 001 wsp.com</p>		<p>Drawing No: 5552/GA/305</p>		<p>REV: C</p>		<p>Drawing Status: S2 - FOR INFORMATION</p>		<p>© WSP UK Ltd</p>			

File name: \\UK\WSPGROUP\COMMON\DATA\PROJECTS\2025\5552\GA\305\5552_GA_305_DWG.dwg, created on 25 February 2019 10:58:44, by David, David